



Prote' 

**WATER
TREATMENT
UNITS**

«2 in 1»

«4 in 1»

Technical Instructions

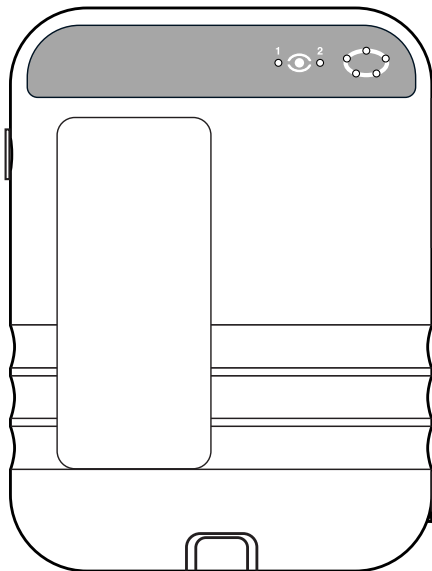

UNIT CONTROLLED BY

UNIT SERIAL NUMBER

Designed and made in France



R1800102 - GB - 06 / 10 - A

Before installation	4
Important! To be read before beginning installation	5
Initial recommendations for installation	6
Internal elements	7
Connecting the unit:	8
Starting up the unit	10
How to use your unit?	10
- The instrument panel	10
- Replacing consumables	11
- Replacing the filter cartridge	11
- Troubleshooting	11
- Precautions to be taken in use	12
Troubleshooting guide	12
Guarantee and precautions for use	13
Guarantee card	17

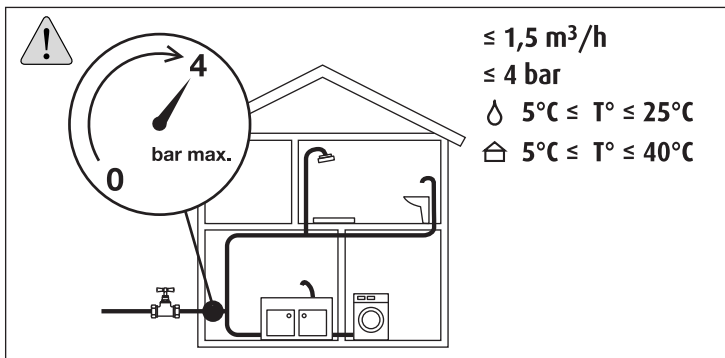
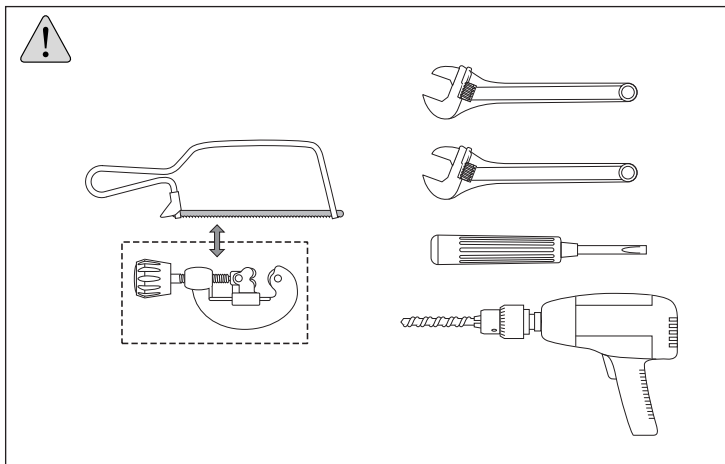



Before installation

Turn the water supply off

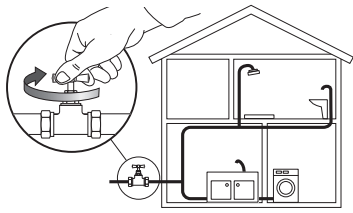

Do not plug

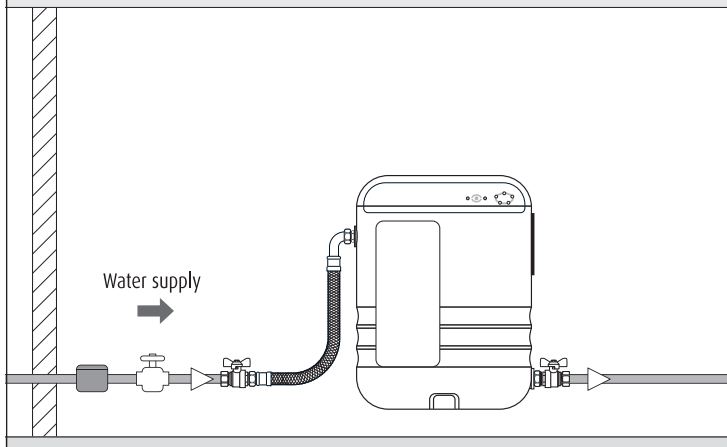
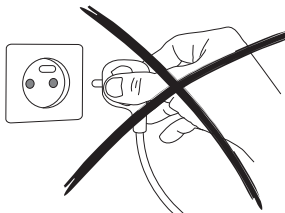



Important! ***To be read before beginning installation***

Before carrying out any operation, cut off the water supply at the mains. Drain the unit at a low point in the domestic water installation. If you need to install an electric plug, cut off the power supply at the circuit-breaker. In any case do not connect the unit electrically for the moment.

Check that:

- The unit is intended for connection to a domestic water supply and not to a bore, well, tank, reservoir, fountain, spring, stream, water course, pond, river, etc.
- The unit is intended to be connected to a cold water supply (between 5 and 25°C) with pressure under 4 bars. Install a water pressure reducer (not supplied) if pressure is higher.

Check that the water flows in the right direction

Before installing the unit, it is important to check that the water flows in the right direction. Your water treatment unit is originally assembled in our works for incoming water to arrive on the left of the unit (on the side of the flexible hose). The arrow on the top of the filter points to the right ("IN" on the left and "OUT" on the right). In this case, water will go through the filter first and then through the electronic scale inhibitor.

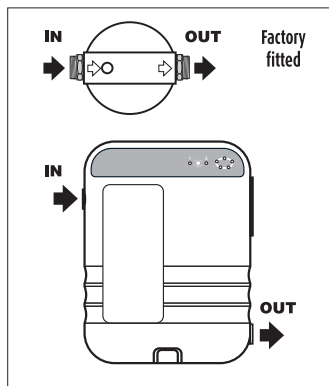

NB. The screws and plugs included with the unit are suitable for fixing on a solid wall (except cellular concrete). If the wall is in a different material, check its solidity (wood, plaster, brick, gypsum board, stone, etc.) and use suitable screws and plugs. Please note, the treatment unit is heavier when full of water.



Initial recommendations for installation

To determine the best position for your unit, check that:

- It is as close as possible to your inlet point from the main supply (technical room, kitchen, etc.);
- The hose is long enough and is not excessively twisted, nor have a bend in it with a radius of less than 15 cm;
- The premises where the unit is installed are inside the home and protected from cold (non-freezing condition);
- The unit does not hinder access to the premises, nor make opening doors difficult...

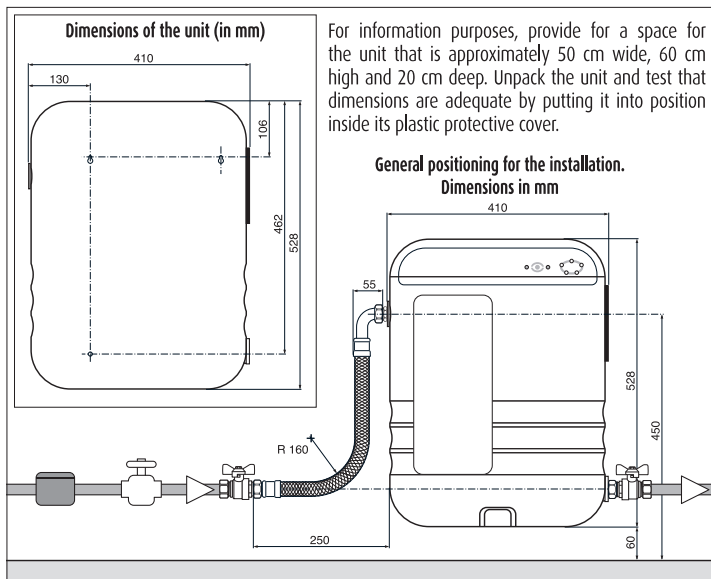

Internal elements

a: flexible hose for water inlet
 b: filter top
 c: air bleeder.
 d: non-return valve (anti-pollution safety).
 e: water treatment cartridge.
 f: filter-bowl seal.
 g: filter nut.
 h: filter bowl.
 i: water drain.

j: wrench holder.
 k: instrument panel
 l: ON-OFF switch and warning light with fuse-holder and 5x20 63mA time-lag fuse.
 m: anti-scale treatment chamber.
 n: 3/4" M/M tap
 o: connection for water outlet

p: mains cable
 q: 5 seals 24 x 14
 r: 1 plastic wrench for loosening/tightening the filter
 s: 3 screws ø 4 and 3 Spit HIT 6/5 type plugs, length 35 mm, Ø 6 mm for fixing the unit in position

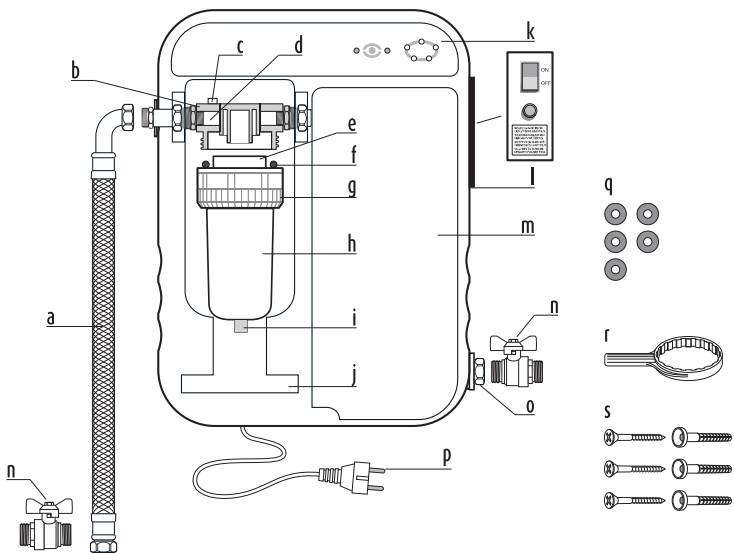

Connecting the unit:

With the flexible hose provided (to be screwed onto the left of the unit).

LOCATING THE UNIT FIXTURE POINTS (fig 1)

Use a 6mm drill adapted for the material to be drilled at the points you have prepared. Drill to a depth of 3.5 cm. Insert the three plugs and screw in the two top screws as far as possible without tightening them. Then unscrew them by three turns. Hang the unit in position on the two screws and screw in as far as possible without tightening. Put the third screw in place at the bottom for holding the unit in position and screw in as far as possible without tightening.

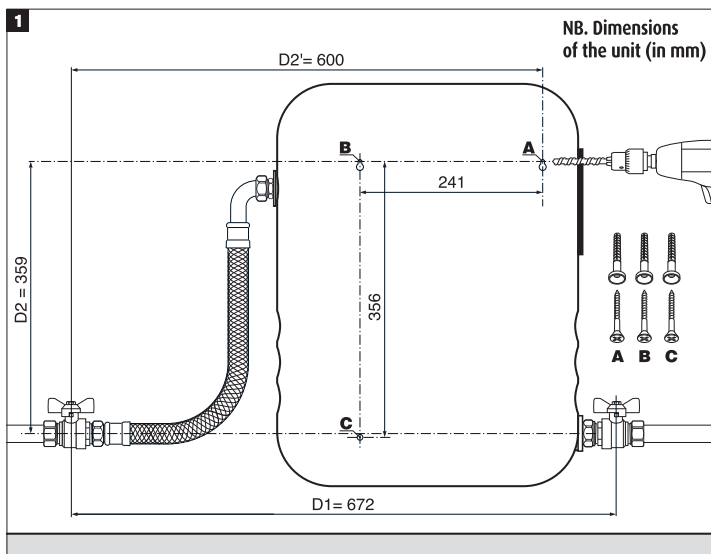

At the bottom on the right of the unit, put a 24x14 seal (supplied) in the female nut to be screwed onto the tap. Screw in the nut without forcing, tightening it with a flat wrench whilst holding the tap in position with a second wrench (fig. 2).

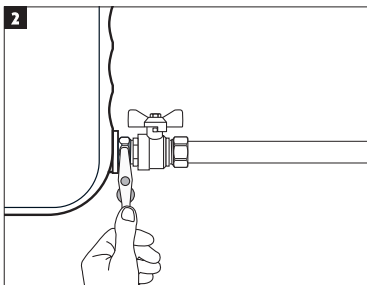

The flexible hose (supplied) is to be screwed in place on the top left-hand side of the unit. Place a 24x14 seal (supplied) in the female part of the angle nut on the hose (fig. 3). Screw in the nut without forcing, tightening the connection inside the unit with another wrench (fig. 4).

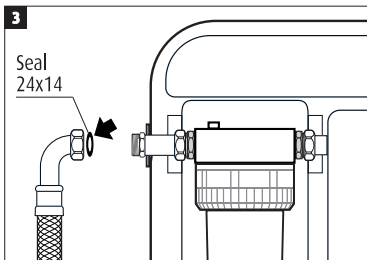

The other end of the hose is to be screwed into the tap. Put a 24x14 seal (supplied) in the female part of the hose nut. Screw in the nut without forcing, tightening it with a flat wrench whilst holding the tap in position with another wrench.

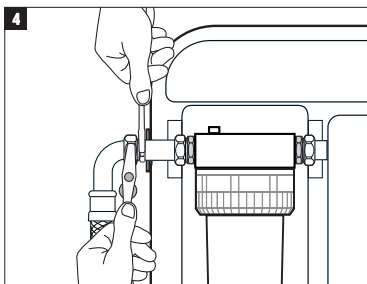

Refit the unit's housing, hooking it into position at the top and then locking it in place at the bottom of the unit with a quarter turn (fig. 5).

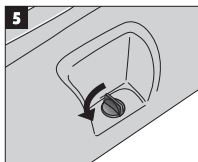

Starting up the unit

Your unit is now ready to run. Before opening up the mains water supply, check that the water-treatment unit is correctly installed. Open the water supply. Open a tap in your home so as to eliminate any air that may have entered the unit and the general installation. Check that there are no leaks on any of the connections and inspect regularly during the first 48 hours of use.

Should any problem occur, cut off the water supply and contact your store or our Consumer Service.

Connect the apparatus electrically to an approved 230 V socket. Switch the unit on with the ON-OFF switch. Check that all the lights operate correctly, the warning light on the ON/OFF switch, the green lights indicating treatment strength "1 or 2" as well as visualisation of "Visio" treatment (blue). Check that the green light 1 and 2 work correctly by changing the position of the strength regulator.

Let the water run out of the tap (for about 5 minutes) before using it for drinking

How to use your unit?

1. The instrument panel

Selecting the strength of treatment

If the average hardness TH of your water is < 25°f: set the scale inhibitor on strength 1.

If your water is hard, TH > 25°f, and creates a great deal of scale, set the scale inhibitor on strength 2 (check the hardness of your water with your local water board).

NB. Your module does not eliminate the calcium and magnesium contained in the water (it does not use salt or chemicals). Therefore the TH in your water remains unchanged between the inlet and outlet points (the unit is not a water softener).

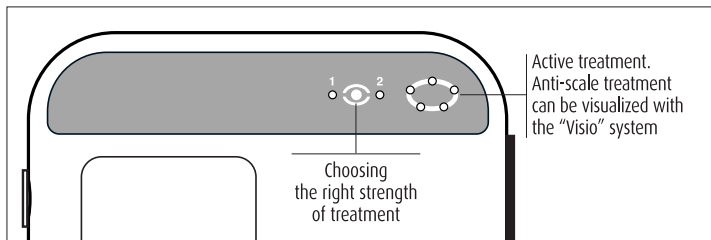

2. Replacing consumables

Your unit requires servicing once every 6 months or up to 45 m³ (for a standard water quality). However, if during different works on your water supply network, a mass of particles (sludge, etc.) should clog your filter, the filter cartridge may need to be replaced beforehand.

Replacing consumables

The filter cartridge is to be changed every 6 months (Indicative value to be adapted to your water quality. Mark down the first start-up date).

- The PROTEO 2 in 1 uses a 25 micron sediment filter cartridge
- The PROTEO 4 in 1 uses a 10 micron sediment filter cartridge and removes bad tastes, chlorine, odours, pesticides and herbicides.

The electronic scale inhibitor requires no maintenance, it is guaranteed for three years. Even so, make sure that the Visio treatment visualisation system is lit.

3. Replacing the filter cartridge

Before carrying out any other operation, put the ON-OFF switch on "OFF" and disconnect the power supply to the unit. Cut off the water at the mains supply. Drain the water contained in the treatment module by unscrewing the water drain unit located at the bottom of the filter bowl (fig. 6). Do not use pliers. Take care to recover the water drained in a recipient. Unscrew the plastic top using the wrench supplied; unscrew anticlockwise. Remove the filter with care (fig. 7); wash the inside of the filter unit with liquid washing-up soap and rinse thoroughly. Replace the filter cartridge with a new one and check the condition of the filter seal, re-screw up the top and the drain and close the cover. Reconnect the power supply to the unit and put the switch in the "ON" position. Open the water at the mains supply or turn on the (red) inlet tap on the unit. Open a tap in your home to eliminate any air contained in the module and the installation.

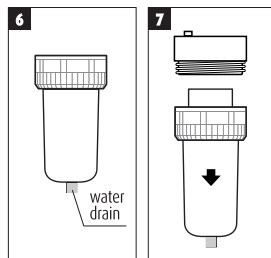

4. Troubleshooting

In all cases, please contact your authorized dealer.

5. Precautions to be taken in use

Do not store treated water for over 24 hours, even in a refrigerator. Open the tap progressively and let the water run for several seconds before drinking.

The water treatment unit must be installed on water pipes inside homes (non-freezing conditions). It has been designed for improving the quality of drinking water distributed by your local water board to your home.

Install the unit on a cold-water pipe (5° to 25°C) with pressure of less than 4 bars. Install a pressure reducer if this is not the case.

The 3-year guarantee does not cover consumable products (see guarantee conditions).

Do not pull on the flexible hose when the treatment unit is in operation. Should the hose be pulled, check the state of the connections. Check the connections regularly and tighten them if any slight leaks appear. Do not let an installation leak deliberately without dealing with the problem and making rapid repairs.

Troubleshooting guide

Warning: Take all necessary precautions for these checks (especially electrical), switch the power OFF. Disconnect the electricity supply to the unit and cut off the water.

Situation	Visible effects	Solutions
The switch is turned "ON"	The unit does not work (no lights come on)	<ul style="list-style-type: none"> - Open the fuse-holder, check the fuse on the unit and replace if necessary with a 5x20 63 mA Time-lag fuse. - Check that the unit is correctly connected. - Check the state of the plug and the cable. - Check that there is power at the socket and at the circuit-breaker
	"Visio" visualisation is not lit, the 1 and 2 lights flash	<ul style="list-style-type: none"> - Contact your authorized dealer.
Selecting the strength of treatment depending on the hardness of the water (strength 1 or 2).	The unit is not operating (no light is on)	<ul style="list-style-type: none"> - Contact your authorized dealer.
Mains water supply tap open	Low pressure	<ul style="list-style-type: none"> - Check the pressure before the water arrives at the unit

Instructions to be kept permanently.

GUARANTEE AND PRECAUTIONS FOR USE

The water quality units are guaranteed for 3 years, excluding consumables, accessories and labour charges.

The COMAP WTI Company guarantees the unit for 3 years. In the event that defects occur due to faulty manufacture or faulty materials, COMAP WTI will bear the costs of repair of the part or parts concerned. If COMAP WTI considers that the product is not repairable, the product or its faulty part will be replaced during the guarantee period.

Guarantee conditions

The guarantee comes into effect as from the time of receipt on our premises of the guarantee card, provided that it has been forwarded to COMAP WTI within 15 days as from the date of purchase. The guarantee card must be filled in carefully and it must be accompanied by the invoice made out at the point of sale or by the installer.

In the event of malfunctions, contact our after-sales service either by telephone, or by email, giving details of the unit type. After acceptance, the after-sales service will forward the procedure linked to the malfunction.

Application of the guarantee is subject to compliance with the sequences and the technical instructions set out in the user manual and the technical data sheet concerning the assembly, servicing and use of the unit.

The guarantee is limited to the units and does not cover consumables (filter elements, salts, resins, lamps, seals) or accessories (fastening brackets, adaptors, seals, fittings, hoses, pressure gauges, switches, indicator lights, fuses, mains lead).

Cases in which the guarantee is not applicable

- Direct intervention to carry out repairs without the prior approval of the after-sales service concerning units or spare parts.
- Misuse, use not in compliance with the user manual, or any other modification or adaptation.
- Damage due to a cause outside the unit, such as a fall of the unit, electrical overvoltage, lightning, storms, fire, gales, natural disasters, water damage, introduction of any foreign bodies or animals in the unit, poor seals on holes drilled, faulty connection of the unit (tubes, hoses, fittings, etc.) not in compliance with the applicable standards, technical recommendations and good professional practice.
- Damage occurring during transport.
- Installation in a country other than the country of purchase.
- Installation for collective use or for industrial premises whereas the technical information linked to the unit does not mention any such use.
- Installation on a pipe supplying water other than that distributed in a public mains water supply network.
- Installation on a pipe not protected from frost, or from temperatures higher than 25°C.
- Installation on a pipe in which the pressure is over 4 bars.
- Electrical connection of the unit to an unsuitable power supply other than 230-240 V alternating current.
- In the event of transfer of the unit to a third party, even against payment.

Safety instructions concerning electrical water quality units and linked to the guarantee

Please read carefully the instructions set out below before using the unit, and keep them in an accessible place for subsequent consultation as and when necessary.

The electrical unit creates a low-level magnetic field. Persons fitted with a pacemaker may note anomalies; in this case, they must move away from the unit and consult their doctor. Do not attempt to dismantle or modify the unit; it contains high-voltage elements and other parts operating at very high temperatures, and such action can involve a risk of burns, fire or electrocution.

Choice of location for the unit

Do not install the unit near alcohol, thinners or any other flammable substance. Contact between any such products and the internal electrical parts of the unit may start a fire or result in electrocution. Place the unit on a flat, solid surface, not exposed to vibrations, and able to bear the weight of the unit.

Do not place any objects alongside the power plug, as it may be necessary to remove the plug from the socket quickly at any time.

Make sure that the relative humidity of the room is between 20% and 80%. Avoid exposing the unit to direct sunlight.

Electrical power supply

Do not damage or modify the power lead or the plug. Do not put heavy objects on the power lead. Do not pull directly on the power lead, or cause it to bend sharply. This could result in electrical damage followed by a fire or electrocution. There is a risk of electrocution if the plug is inserted in or removed from the socket with wet hands. Do not overload the socket with too great a number of electrical appliances, as this may lead to a fire or electrocution. The unit must be plugged in to a standard three-pin mains socket with 230-240V AC current. Use only the type of electricity supply shown on the label located on the unit, to avoid a risk of fire, electrocution or a malfunction. If the type of power supply is not known, contact the local electricity company.

Do not leave the power lead close to objects giving off heat. The outer sheathing of the lead may melt and cause a fire or electrocution.

Before plugging the power lead in, make sure that it is fully unwound and that it is not knotted. Knots or kinks in the lead could cause a fire or electrocution.

ATTENTION

During a thunderstorm, switch the unit off and unplug the power lead (certain types of information stored in the memory may be deleted when the unit is switched off). Switch the unit off and unplug the power lead if the unit is not to be used for a long period, such as during holiday periods.

If dust has built up on the power lead plug while it is in the mains power socket, unplug the unit and clean the plug with a clean, dry cloth. Do not plug the unit in a socket that is also used to power other units such

as an air conditioning unit, household appliances or hi-fi equipment. These units generate electrical noise that may interfere with the operation of your unit.

Handling

Do not drop any metal objects into the unit. Do not spill any flammable liquids or substances on or near it. If they come into contact with the internal high-voltage areas, this may cause a fire or electrocution. If an object falls into the unit or if a liquid is spilled on it, switch the unit off immediately and unplug the lead from the mains power socket, with dry hands. Then contact our after sales service. Do not use any aerosol products with flammable contents close to the unit. If the gas they contain comes into contact with one of the internal electrical components of the unit, there could be a risk of fire. The unit contains high-voltage components. In the event of accessing the inside of the unit, do not allow any metal objects to come into contact with the internal components of the unit, as this may cause burns or electrocution.

Avoid pressing too hard on the covers and control panels on the unit.

This could result in injury, and/or damage to the unit.

Never lift the unit by any of its hydraulic or electrical connections.

Cleaning and servicing

Carry out only the servicing procedures set out in the user manual. If other servicing operations are necessary, contact our after-sales service. Clean the unit regularly. Accumulation of dust may prevent the unit from operating correctly.



2 in 1 / 4 in 1 GUARANTEE CARD

Please cut this card out, fill it in, and send it to the following address within 15 days of purchase:

COMAP WTI - Z.I. LES PETITS CHAMPS - F - 26120 MONTELIER

THE GUARANTEE IS ONLY VALIDATED IF THE CARD IS FILLED IN CAREFULLY AND SENT TO US WITHIN 15 DAYS AS FROM THE DATE OF PURCHASE, TOGETHER WITH THE ORIGINAL COPY OF YOUR INVOICE OR YOUR TILL RECEIPT.

Name : FirstName:

Address:

Post code: Town: Country: Tél:

Serial number of the unit (see sticker on the technical requirements document) :

Date of purchase: (please enclose the original copy of your invoice or till receipt)

Name of the store:

Location of the store (town):

To enable us to provide you with the best service and the highest quality, we would be grateful if you could fill in the questionnaire below (this is not an obligation):

■ Home

Are you installing this unit?

- in your main home: Yes No
- in your second home: Yes No
- in a town: Yes No
- in the country: Yes No

Do you own your home? Yes No

- What year was your home built in?
- What is the surface area of your home?

.....

What types of equipment do you have?

- Kitchen: Number: - Boiler (central heating + hot water): Yes No
- Bathroom: Number: - Electric immersion heater: Yes No
- Laundry room: Number:
- Toilet: Number:

■ *Why did you choose this unit?*

- Unpleasant taste of the water (e.g. chlorine): Yes No
- Cloudy water: Yes No
- Water too hard: Yes No
- Fear of unwanted substances (nitrates): Yes No

- Fear of toxic products (lead): Yes No
- Fear of bacteria: Yes No
- Fear of pesticides: Yes No
- Other reasons:

This information is intended for COMAP WTI and cannot be forwarded to any persons outside the company. You can access it at any time and request such rectifications as may be necessary (French law dated 06/01/1978 - computers and personal rights).



COMAP WTI
Z.I. LES PETITS CHAMPS
F - 26120 MONTELIER
FRANCE

e-mail: comapwti@comap.fr
website : www.comapwti.fr